

To run a GPS hunt on your own iPhone or Android phone you need to ensure LOCATION SERVICES are tuned on, on the device and on the browser you use...

If you have an iPhone....

1. Go to **Settings**
2. Go to **Privacy**
3. Click on **Location Services** (in the pic it shows it's turned on)
4. Step 4 shows where you can slide to **ON**
5. When turned on, a list will show below, allowing you to turn Location Services On or OFF for specific applications. Find the **BROWSER** you use in this list, i.e. safari, and turn that button **ON** too.



Depending on which iPhone you have, this process might be slightly different, you can check your mobile device is set up correctly by trying our sample hunt by following the below link. If you are having any difficulties do get in touch.

<http://www.huntfun.co.uk/CorporateGPS/home.php>

Please follow the instructions below for Android Version 6

If you have an Android phone....

1. **SWIPE DOWN** on your home screen, there is an icon that shows if Location is turned on - if not on **TURN ON** by clicking on it..

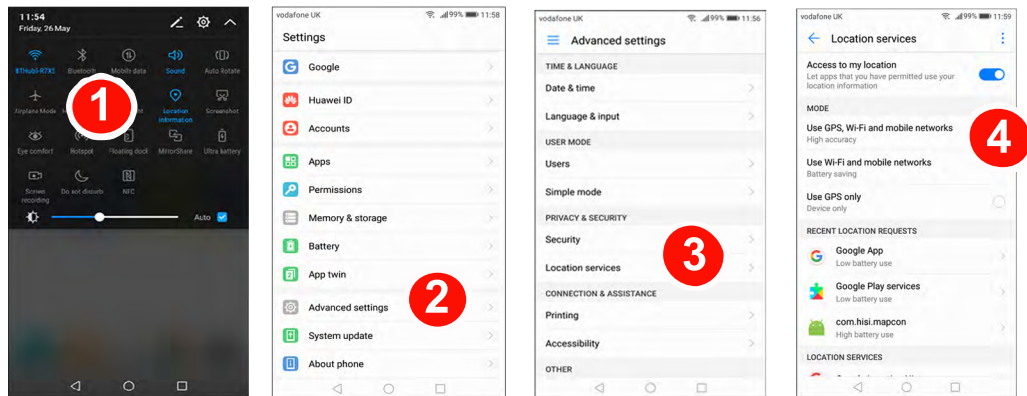

Next you need to check your LOCATION ACCURACY

2. Press the **settings icon** and click the Advance settings in **SETTINGS**
3. Click on **Location services**
4. Allow **Access to my location** and use **High Accuracy mode**

## Please follow the instructions below for Android Version 5

1. **SWIPE DOWN** on your home screen, there is an icon that shows if Location is turned on - if not on **TURN ON** by clicking on it..

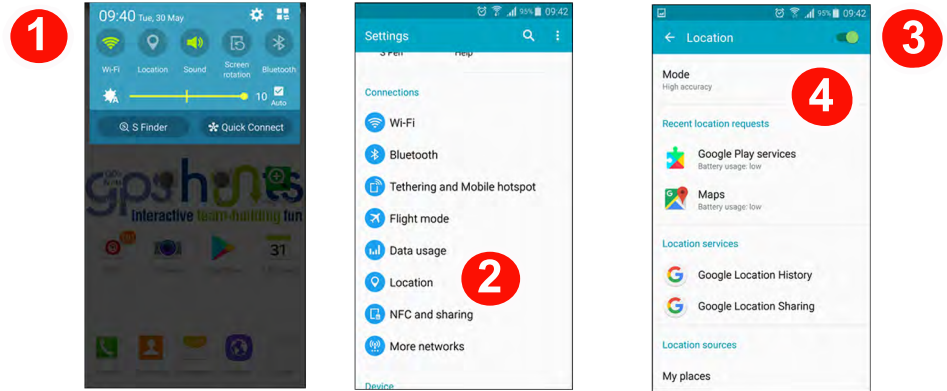

Next you need to check your **LOCATION ACCURACY**

2. Press the **settings icon** and click the Location in **SETTINGS**
3. Turn on Location
4. Change Mode to High Accuracy

## Please follow the instructions below for Android Version 4

1. **SWIPE DOWN** on your home screen, there is an icon that shows if Location is turned on - if not on **TURN ON** by clicking on it..

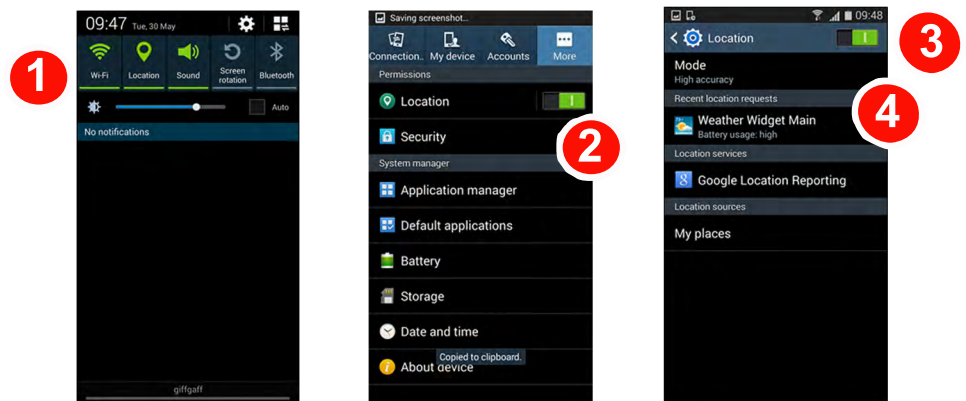

Next you need to check your **LOCATION ACCURACY**

2. Press the **settings icon** and click More in **SETTINGS**
3. Turn on Location
4. Change Mode to High Accuracy

Depending on which Android phone you have, this process might be slightly different , you can check your mobile device is set up correctly by trying our sample hunt at <http://www.huntfun.co.uk/CorporateGPS/home.php>

If you are having any difficulties do get in touch.